

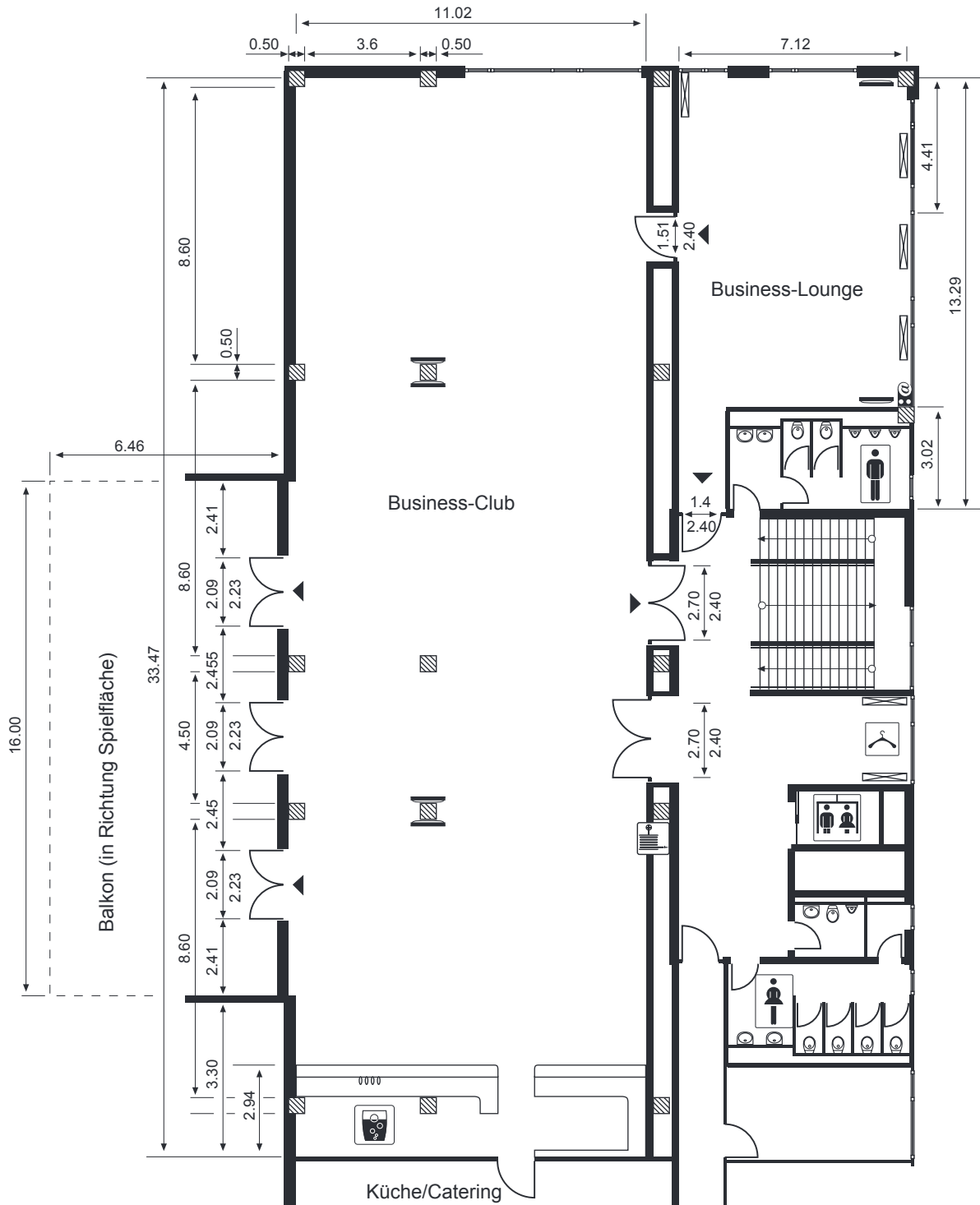





Die MDOC-Arena – Ebene 1/Business-Club, Business-Lounge, Grundriss

				Kapazität	
Business-Club	Brutto	368,83 m ²	Business-Lounge	Brutto	77,34 m ²
	Netto	331,00 m ²		Netto	70,00 m ²
	Raumhöhe	3,10 m		Raumhöhe	2,60 m
	Aufbauhöhe	3,00 m		Aufbauhöhe	2,55 m
Gesamt		Brutto	446,17 m ²		
		Netto	401,00 m ²		



-  Pfeiler (0,50 m x 0,50 m)
-  Heizkörper
-  Garderobe (mobil)
-  TV
-  Wandhydrant
-  Anschlüsse für Medien

