

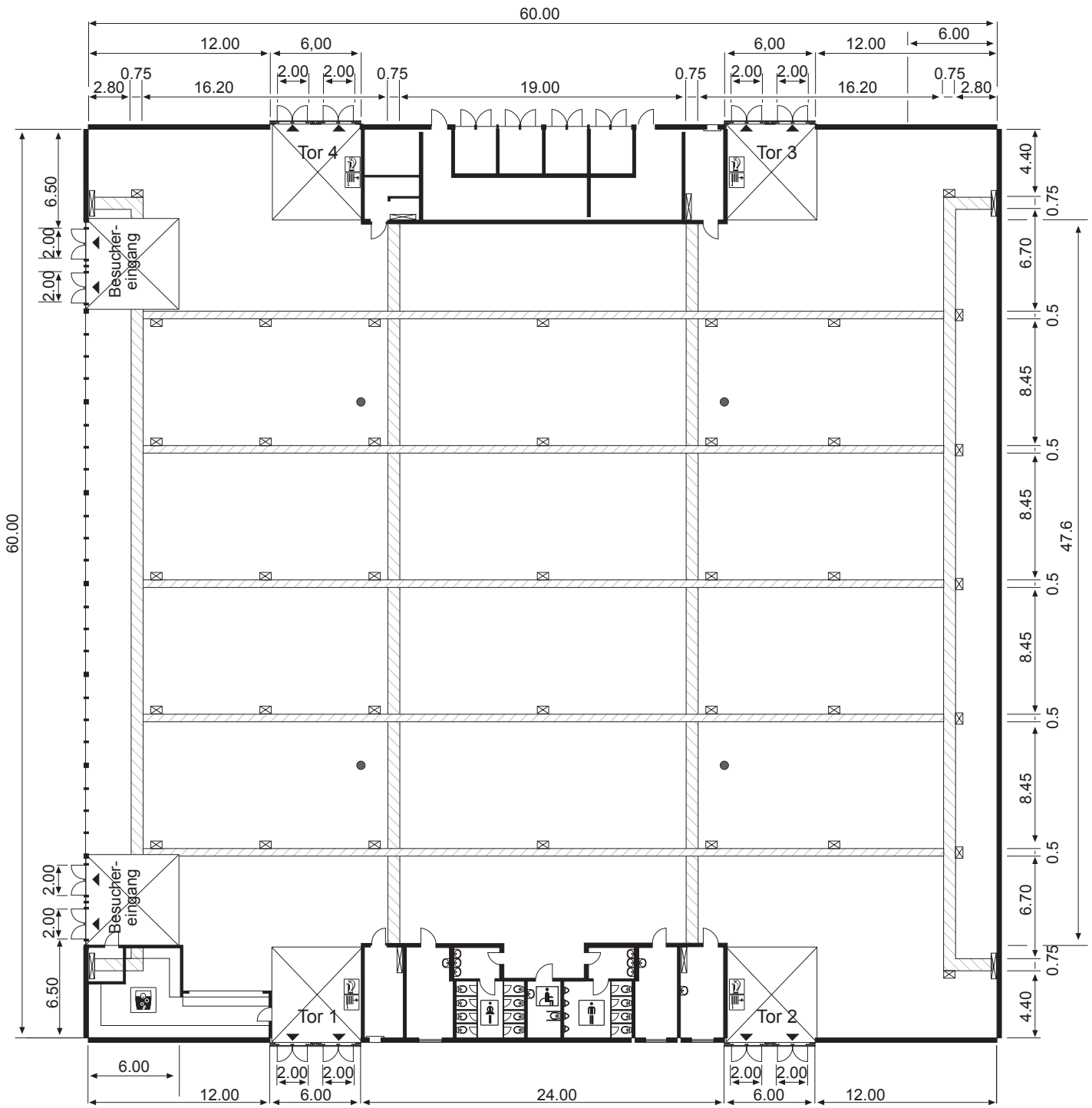



Die MESSE MAGDEBURG – Halle 2, Grundriss mit Medien

Kapazität
 Bruttofläche
 60 m x 60 m = 3.600 m²
 Nettofläche
 3.014,4 m²



-  Pfeiler \varnothing 0,50 m
-  Tor 1–4 Schiebetoranlage
lichte Breite x lichte Höhe
4,90 m x 4,50 m
-  Kabelschacht
-  Wasser- und Abwasseranschluss
-  Notausgangstüren
lichte Breite x lichte Höhe
2,00 m x 2,65 m

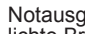